

INMAN INDUSTRIAL PARK REPLAT (A Replat of a Portion of Inman Industrial Park)

SURVEYOR'S CERTIFICATE AND DESCRIPTION

I, the undersigned, Registered Land Surveyor in the State of Kansas, do hereby certify that the following described tract of land was surveyed on March 1979 and the accompanying final plat prepared and that all the monuments shown herein actually exist and their positions are correctly shown to the best of my knowledge and belief:

A portion of Inman Industrial Park, City of Inman, McPherson County, Kansas, as originally platted, being more particularly described as follows:

Lots 1, 2, 3, 4, 5, 6, 8 and 9; The vacated alley between Lots 6 and 8, and Lots 6 and 9; The vacated Industrial Drive from Kansas Highway No. 61 to the South line of Ranch Land Drive.

The above described tract of land contains 20.153 acres more or less.

Date signed: March 28, 1979

Robert L. Moser
License # 452 Robert L. Moser, L.S.

OWNER'S CERTIFICATION AND DEDICATION

STATE OF KANSAS)
COUNTY OF McPHERSON) SS

This is to certify that the undersigned (owner)(owners) of the land described in the Surveyor's Certificate; have caused the same to be surveyed and subdivided on the accompanying plat into lots, blocks, streets and other public ways under the name of Inman Industrial Park Replat; that all highways, streets, alleys, easements and public grounds as denoted on the plat are hereby dedicated to and for the use of the public for the purpose of constructing, operating, maintaining and repairing public improvements; and further that the land contained herein is held and shall be conveyed subject to any restrictions, reservations, and covenants on file or hereafter filed in the Office of the Register of Deeds of McPherson County, Kansas.

Date Signed: 3-28-79

Date Signed: 3-28-79

Garry Hostetler (Owner's Signature)
Charles Embert (Owner's Signature)

Owners of lands within this subdivision do hereby bind themselves to waive any protest to annexation by the City of Inman.

NOTARY CERTIFICATE

STATE OF KANSAS)
COUNTY OF McPHERSON) SS

The foregoing instrument was acknowledged before me this 28th day of March, 1979, by Garry Hostetler and Charles Embert

(SEAL)

Mary Ann Smith
Notary Public

My Appointment expires: Feb 21, 1983

PLANNING AGENCY CERTIFICATE

STATE OF KANSAS)
CITY OF INMAN) SS

This plat was approved by the Inman City Planning Commission on March 28, 1979, and was recommended for approval by the Governing Body of the City of Inman, Kansas.

Date Signed: 3-28-79

ATTEST: Adolf C. Brantley
Chairman

Rene Karmel, Secretary

GOVERNING BODY CERTIFICATE

STATE OF KANSAS)
CITY OF INMAN) SS

This plat approved and all dedications shown hereon, if any, are hereby accepted by the Governing Body of the City of Inman, Kansas, on 4-7, 1979.

ATTEST: Melvin J. Ferguson
City Clerk

Adolf W. Hensfield
Mayor

(SEAL)

CITY ATTORNEY'S CERTIFICATE

This is to certify that this plat has been submitted to me and that the same is hereby approved this 11th day of April, 1979.

Robert F. Stora
City Attorney, Inman, Kansas

COUNTY COMMISSIONERS' CERTIFICATE

STATE OF KANSAS)
COUNTY OF McPHERSON) SS

The dedications shown on this plat are hereby accepted by the Board of County Commissioners, McPherson County, Kansas, on April 16, 1979.

ATTEST: Margaret Bryan
County Clerk

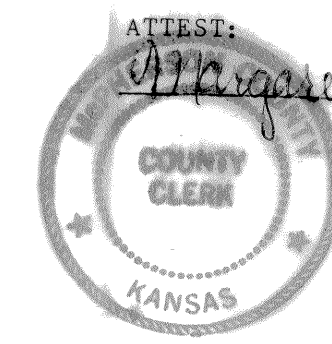

COUNTY ATTORNEY'S CERTIFICATE

This is to certify that this plat has been submitted to me and that the same is hereby approved this 11th day of April, 1979.

Jim K. Knutson
County Attorney, McPherson County, Kansas

COUNTY CLERK AND CITY CLERK CERTIFICATE

STATE OF KANSAS)
COUNTY OF McPHERSON) SS
CITY OF INMAN)

We, the undersigned, County Clerk of McPherson County, Kansas, and City Clerk of the City of Inman, Kansas, within our respective jurisdictions, do hereby certify that at the date of this certificate, all currently due and owing taxes and special assessments of any kind assessed against any of the land included in this plat, have been paid.

Date Signed: April 16, 1979

Date Signed: 4-7-79

Margaret Bryan
County Clerk

Melvin J. Ferguson
City Clerk

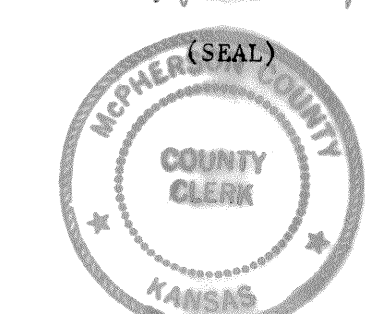

Entered on transfer record on April 16, 1979.

Margaret Bryan
County Clerk

REGISTER OF DEEDS CERTIFICATE

STATE OF KANSAS)
COUNTY OF McPHERSON) SS

This is to certify that this instrument was filed for record in the Register of Deeds Office, at 8:45 a.m. - p.m., on the 16 day of April, 1979.

Plat # A Page 58
Rosalie Nelson, Register of Deeds

Deputy

(SEAL)

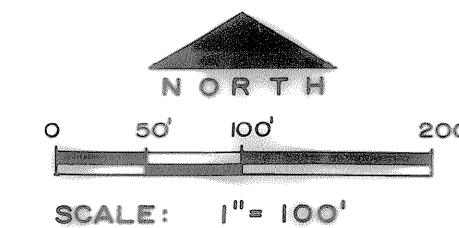

LEGEND

- Section Corner
- Subdivision Corner
- Radius Points
- Road or Railroad
- Right of Way Line
- Subdivision Boundary
- Lot Line
- Building Setback Line

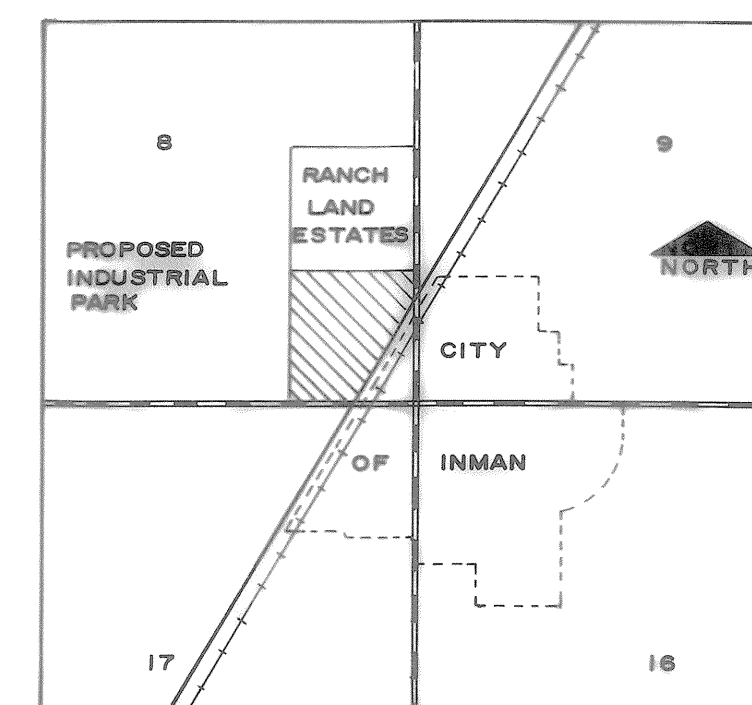

VICINITY MAP

CERTIFICATE AS TO COUNTY PUBLIC IMPROVEMENTS

STATE OF KANSAS)
COUNTY OF McPHERSON) SS

I, the undersigned, do hereby certify that there are no required improvements pertaining to the subject plat and not under other Federal, State or City completion obligations.

Date Signed: April 16, 1979

Melvin J. Ferguson
McPherson County Engineer

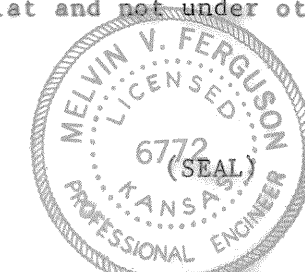

Ordinance # 236
Annexation of lands
to Inman City
Mar. 22, 1978

moser & associates
consultants-engineers-architects
newton, kansas 67114

INMAN INDUSTRIAL PARK REPLAT

FINAL PLAT SCALE: 1" = 100' DRAWN BY: TLS

OWNER - SUBDIVIDER

GARRY HOSTETLER DEVELOPMENT, INC.

DATE: 3-26-79 APPROVED BY: 113 S. MAIN INMAN, KANSAS DRAWING NUMBER: 1579